

Ton-1 is designed to be as flexible as possible.

 **700 sq m**

The studio has been sustainably repurposed to a best-in-class specification.

 **1,000+ people**

Capable of accommodating more than 1,000 people.

 **15+ configurations**

A highly adaptable and bespoke curtain rail system allows for subdivision into more than 15 possible configurations, enabling the space to accommodate all sized groups, learning and workshop styles.

Be that concerts, conferences, exhibitions, film screenings or workshops, the possibilities are endless. Additional catering and workspaces spaces add to this flexibility.

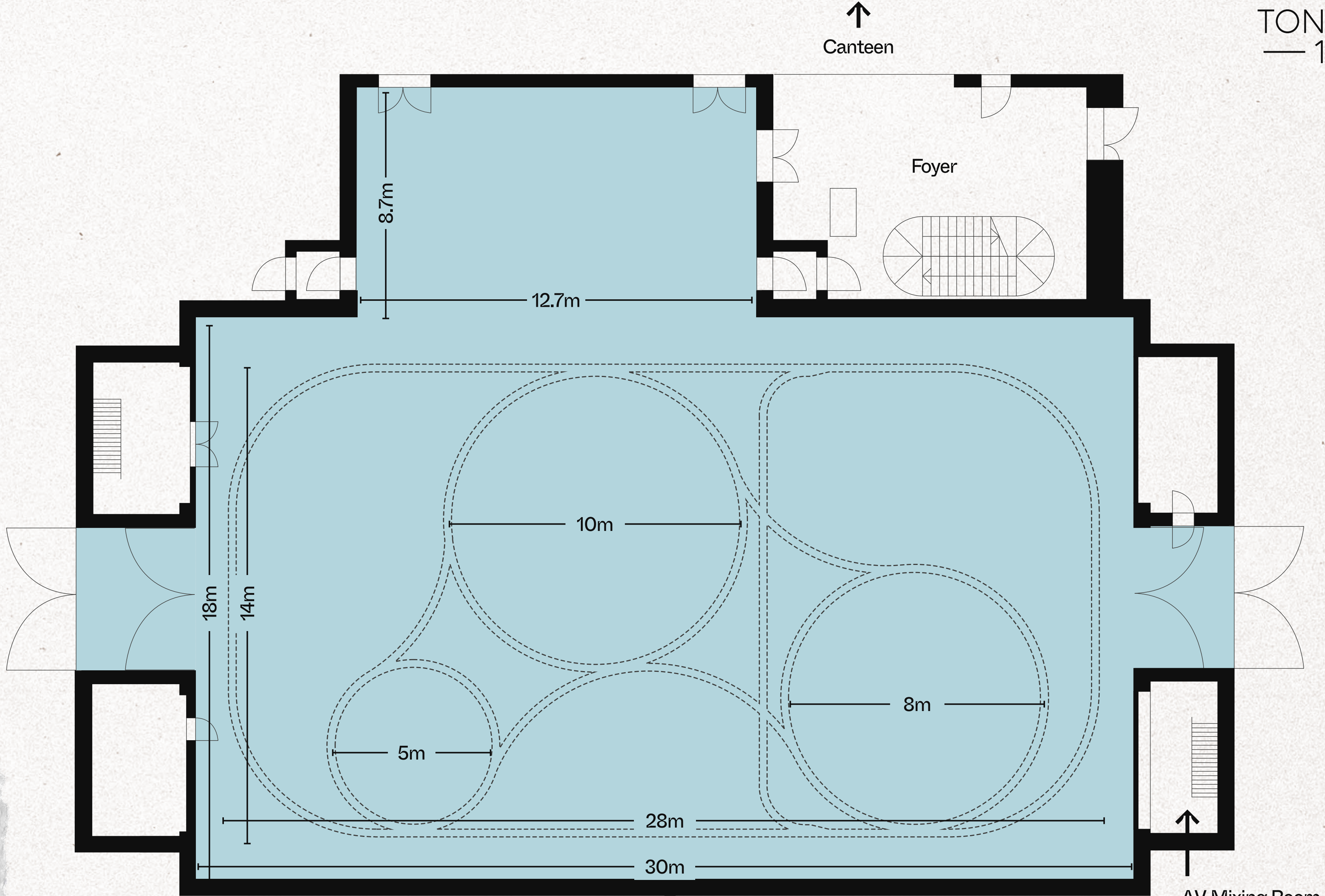

Floor to ceiling height
6.65m to Skyrail

TON
— 1